



More Precision

capa**NCDT** // Capacitive displacement sensors and systems





- Compact and robust construction
- High temperature stability
- Nanometer repeatability
- Suitable for all conductive materials
- 24 V (9 – 36 V) standard power supply for industrial applications
- Ideal for OEM applications
- Suitable for practically all sensors

System design

The capaNCDT 6110 single channel capacitive electronics is compatible with all Micro-Epsilon capacitive sensor ranges. The analog measuring system stands out due to its compact design together with high performance. Due to the miniaturized design and its ease of use, the capaNCDT 6120 is ideally suited to integration in machines and facilities. The flexible 9-36 V power supply, enables the capaNCDT 6110 series to also be used in mobile applications. The capaNCDT 6110 stands out due to its excellent price/performance ratio, which makes it particularly suitable for high volume applications.

A measuring system consists of:

- Capacitive displacement sensor
- Sensor cable
- Controller
- Supply and signal output cable

Accessories:

- Power supply

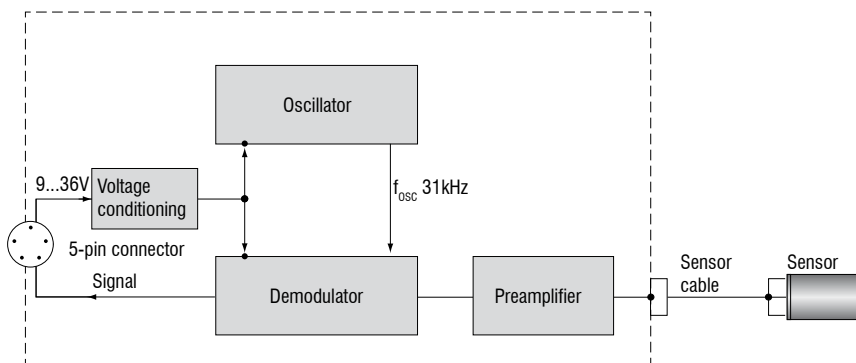

| Controller type | DT6110 | DT6110/ECL2 | DT6112 |
|--------------------------------------|--|--|--|
| Resolution static | 0.01 % FSO | 0.01 % FSO | 0.01 % FSO |
| Resolution dynamic | 0.015 % FSO (1 kHz) | 0.015 % FSO (1 kHz) | 0.03 % FSO (20 kHz) |
| Bandwidth | 1 kHz (-3 dB) | 1 kHz (-3 dB) | 20 kHz (-3 dB) |
| Linearity (typ.) | $\leq \pm 0.05$ % FSO | $\leq \pm 0.05$ % FSO | $\leq \pm 0.1$ % FSO |
| Sensitivity deviation | $\leq \pm 0.1$ % FSO | $\leq \pm 0.1$ % FSO | $\leq \pm 0.1$ % FSO |
| Long-term stability | < 0.05 % FSO/month | < 0.05 % FSO/month | < 0.05 % FSO/month |
| Synchronous operation | no | no | no |
| Insulator measurement | no | no | no |
| Temperature stability | 200 ppm | 200 ppm | 200 ppm |
| Temperature range (during operation) | Sensor | -50 ... +200 °C | -50 ... +200 °C |
| | Controller | +10 ... +60 °C | +10 ... +60 °C |
| Temperature range (storage) | -10 ... +75 °C | -10 ... +75 °C | -10 ... +75 °C |
| Supply | 24 VDC/55 mA (9 - 36 V) | 24 VDC/55 mA (9 - 36 V) | 24 VDC/55 mA (9 - 36 V) |
| Output | 0 ... 10 V (short-circuit-proof), optional: ± 5 V, 10 ... 0 V | 0 ... 10 V (short-circuit-proof), optional: ± 5 V, 10 ... 0 V | 0 ... 10 V (short-circuit-proof), optional: ± 5 V, 10 ... 0 V |
| Sensors | suitable for all sensors | suitable for all sensors | suitable for all sensors |
| Sensor cable | CC cable ≤ 1 m CCm cable = 1.4 m CCg cable = 2 m | CC cable ≤ 2 m CCm cable = 2.8 m CCg cable = 4 m | CC cable ≤ 1 m CCm cable = 1.4 m CCg cable = 2 m |

FSO = Full Scale Output

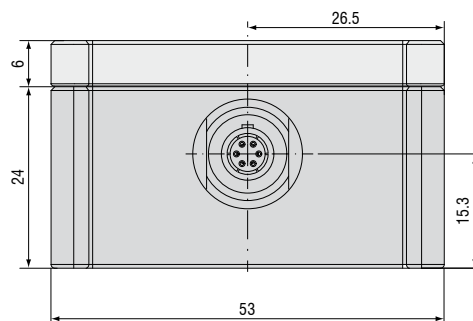
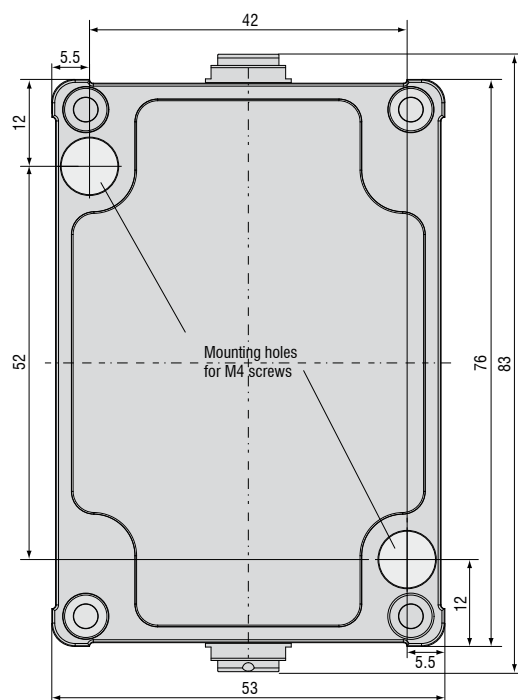

| Sensor cable | Cable CCx,x / CCx,x/90 | Cable CCmx,x / CCmx,x/90 | Cable CCgx,x / CCgx,x/90 |
|-----------------------|--|---|--|
| Description | Low-outgassing cable up to 4 m length, for applications in clean rooms | Low-outgassing cable up to 4.2 m length, for applications in clean rooms, UHV and EUV | Robust cable up to 8 m length, for industrial applications |
| Temperature stability | -100 °C to +200 °C | -100 °C to +200 °C | -20 °C to +80 °C (permanent) -20 °C to +100 °C (10;000 h) |
| Outer diameter | 3.1 mm ±0.1 mm | 2.1 mm ±0.1 mm | 3.1 mm ±0.1 mm |
| Bending radius | 3x cable diameter during installation; 7x cable diameter for movement; 12x cable diameter recommend at continuous movement | | |

| Design | Cable with connector type C for sensors CS005 / CS02 / CS05 / CSE05 / CS08 / CSE1 | | | | | | Cable with connector type B for sensors CS1 / CS1HP / CSE1,25 / CS2 / CSE2 / CS3 / CSE3 / CS5 / CS10 | | | | | |
|--------------|--|---------|---------|----------------------------------|------------|------------|---|---------|---------|----------------------------------|------------|------------|
| | 2 x straight connector | | | 1 x straight / 1 x 90° connector | | | 2 x straight connector | | | 1 x straight / 1 x 90° connector | | |
| Model | CCx,xC | CCmx,xC | CCgx,xC | CCx,xC/90 | CCmx,xC/90 | CCgx,xC/90 | CCx,xB | CCmx,xB | CCgx,xB | CCx,xB/90 | CCmx,xB/90 | CCgx,xB/90 |
| Standard 1 m | • | | • | • | | • | • | | • | • | | • |
| 1.4 m | | • | | | • | | | • | | | • | |
| 2 m | • | | • | • | | • | • | | • | • | | • |
| 2.8 m | | • | | | • | | | • | | | • | |
| 3 m | • | | | • | | • | • | | • | • | | • |
| 4 m | | | • | | | • | | | • | | | • |
| 4.2 m | | • | | | • | | | • | | | • | |
| 6 m | | | • | | | • | | | • | | | • |
| 8 m | | | • | | | • | | | • | | | • |

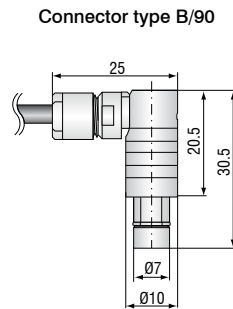
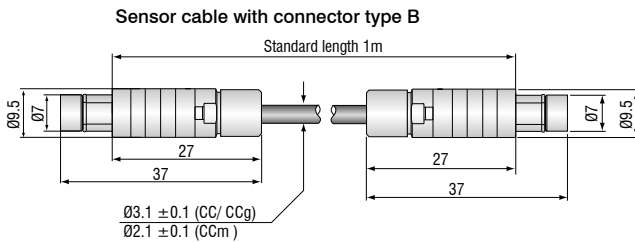
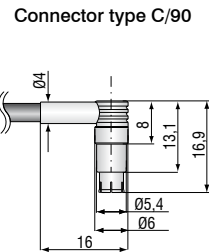
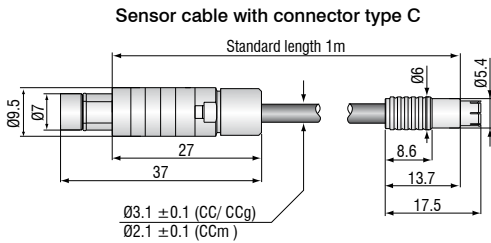

| Accessories | capaNCDT | 6110 | 6200 | 6500 |
|--|----------|------|------|------|
| MC2.5 Micrometer for sensor calibration, range 0 - 2.5 mm, Resolution 0.1 µm. Suitable for sensors CS005 to CS2 | | • | • | • |
| MC25D Digital micrometer for sensor calibration, range 0 - 25 mm, adjustable offset (zero). Suitable for all sensors. | | • | • | • |
| HV/B Vacuum feed through triaxial | | • | • | • |
| UHV/B Vacuum feed through triaxial for ultra-high vacuum | | • | • | • |
| PC6200-3/4 Power-/trigger cable, 4 pin, 3 m | | | • | |
| SCAC3/4 Signal output cable, (necessary for multi-channel applications), 4 pin, 3 m | | | • | |
| SCAC3/5 Signal output cable, analog, 5 pin, 3 m | | • | | |
| SC6000-1,0 Synchronization cable, 5 pin, 1 m | | | • | • |
| CA5 Pre-amplifier cable 5 pin, 5 m | | | | • |
| PS2020 Power supply for DIN rail mounting; Input 230 VAC (115 VAC); Output 24 VDC / 2.5 A; L/W/H 120x120x40 mm | | • | • | |

HV/B Vacuum feed through (Art.-no. 0323050)

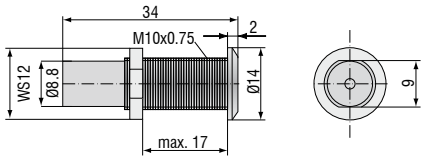

Max. leak rate 1×10^{-7} mbar · l s⁻¹, compatible with connector type B

UHV/B Vacuum feed triax weldable (Art.-no. 0323346)

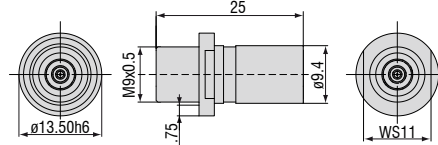

Max. leak rate 1×10^{-9} mbar · l s⁻¹, compatible with connector type B

UHV/B Vacuum feed triax with flange CF16 (Art.-no. 0323349)

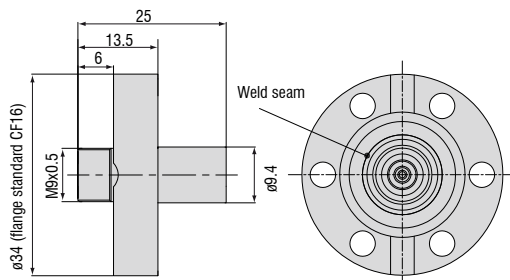

Max. leak rate 1×10^{-9} mbar · l s⁻¹, compatible with connector type B

UHV/B Vacuum feed triax screwable (Art.-no. 0323370)

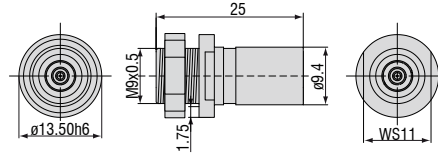

Max. leak rate 1×10^{-9} mbar · l s⁻¹, compatible with connector type B

SCAC3/4 Signal output cable (Art.-no. 2902104)

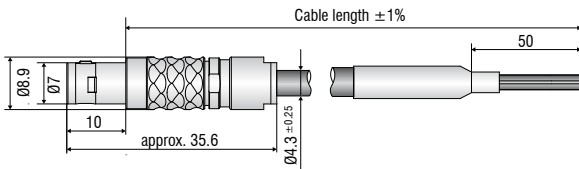

SCAC3/5 Signal output cable (Art.-no. 2902112)

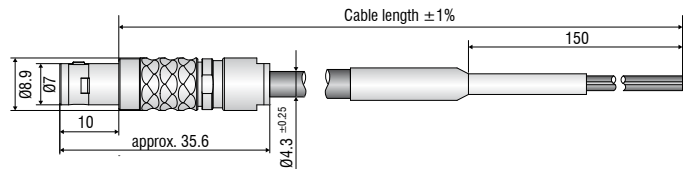

PC6200-3/4 Power-/trigger cable (Art.-no. 2901881)

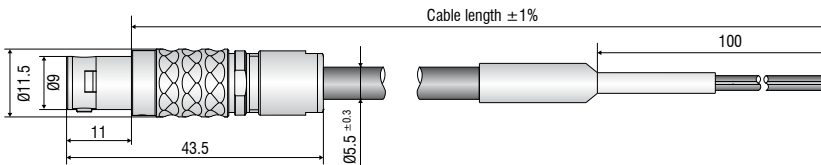

SC6000-1,0 Synchronization cable (Art.-no. 2903473)

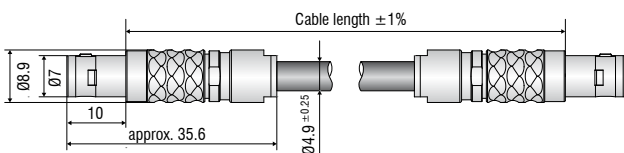

CA5 Preamplifier cable (Art.-no. 2903180)

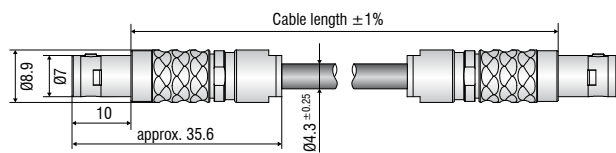

High performance sensors made by Micro-Epsilon



Sensors and systems for displacement and position



Sensors and measurement devices for non-contact temperature measurement



2D/3D profile sensors (laser scanner)



Optical micrometers, fiber optic sensors and fiber optics



Color recognition sensors, LED analyzers and color inline spectrometer



Measurement and inspection systems